



Fiscal Year 2013
Master Plan Update

SEVEN PLANNING PRINCIPLES

Western Illinois University
**The Campus Is the Classroom:
Macomb Master Plan**

*Creating facilities for the leading comprehensive
university in the United States.*



Our Values

Academic Excellence
Educational Opportunity
Personal Growth
Social Responsibility



1. Learner Centered Campus
2. Linkages Between Campus Areas
3. Aesthetically Pleasing Appearance
4. Accommodating Growth
5. Strong Utility and Technology Infrastructure
6. Community Interface
7. Flexibility

1: LEARNER CENTERED CAMPUS

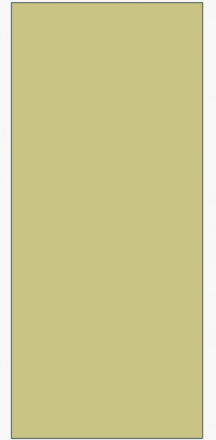

PERFORMING ARTS CENTER



PERFORMING ARTS CENTER



RIVERFRONT PHASE I OPENING JANUARY 2012



RIVERFRONT PHASE I OPENING JANUARY 2012



RIVERFRONT PHASE II GROUNDBREAKING AUGUST 2012



RIVERFRONT PHASE II GROUNDBREAKING AUGUST 2012



RIVERFRONT PHASE II GROUNDBREAKING AUGUST 2012



IMPROVEMENTS IN THE SCIENCES, SCIENCE EDUCATION, NURSING, AND RESEARCH



CURRENS 419, 423, 431



HORRABIN 62



CURRENS 114 AND 116



CURRENS 114 AND 116



CURRENS 125



KNOBLAUCH 301



3-D ART FACILITY OPENED SEPTEMBER 2012



3-D ART FACILITY METALS, CERAMICS, AND SCULPTURE



3-D ART FACILITY METALS, CERAMICS, AND SCULPTURE



TANNER BROADCAST FACILITY



TANNER ELECTRONIC CLASSROOM



CORBIN-OLSON RENDERING SHOWN IN 2011



CORBIN OLSON RIBBON CUTTING SEPTEMBER 2012



CORBIN-OLSON COMMONS



CORBIN-OLSON COMMONS



OLSON COMPUTER LAB



DIGITAL COMMONS DESIGN

DECEMBER 2011

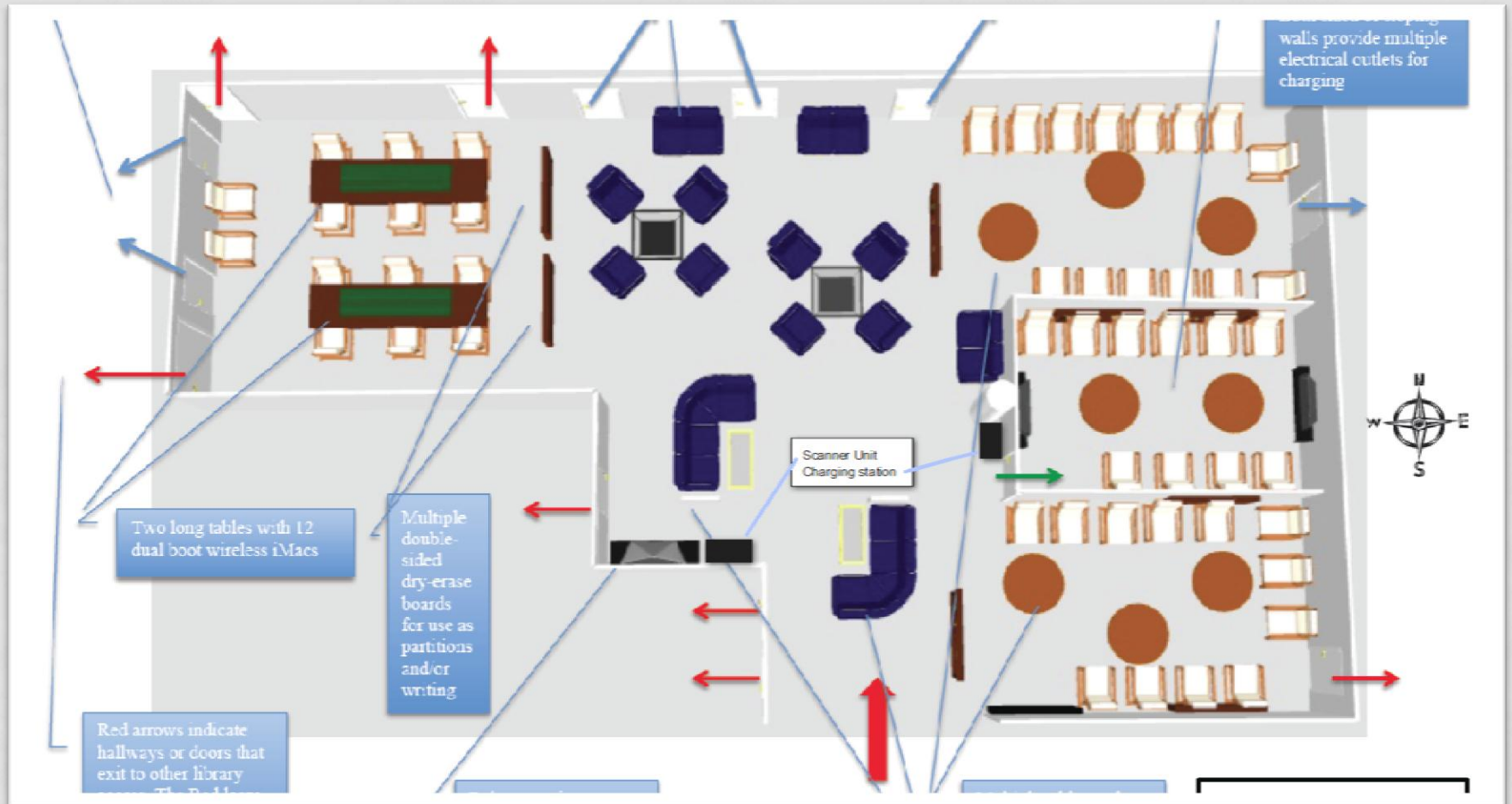

DIGITAL COMMONS



DIGITAL COMMONS



2: LINKAGES BETWEEN CAMPUS AREAS

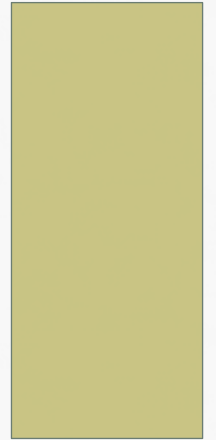

ACCESSIBILITY ENHANCEMENTS

- Completing *Americans with Disability Act (ADA)* accessible bathroom renovations in:
 - Heating Plant Annex
 - Lincoln/Washington
 - Corbin/Olson
- New accessible door openers in:
 - Browne
 - Horrabin
 - Sherman

LANDSCAPE ENHANCEMENTS: SEATING AREAS IN THE MALL



LANDSCAPE ENHANCEMENTS: ALUMNI WALL



LANDSCAPE ENHANCEMENTS: ALUMNI WALL



LANDSCAPE ENHANCEMENTS: CAMPUS WE CARE ACTIVITIES

Macomb



Quad Cities



PEDESTRIAN-VEHICULAR ENHANCEMENTS: NEW BUS CUT-OUTS

Corbin-Olson



Lincoln-Washington



PEDESTRIAN-VEHICULAR ENHANCEMENTS: CHARLES STREET



PEDESTRIAN-VEHICULAR ENHANCEMENTS: 34TH AVE. AND RIVER DRIVE



PEDESTRIAN-VEHICULAR ENHANCEMENTS: RIVER DRIVE



PEDESTRIAN-VEHICULAR ENHANCEMENTS: UNIVERSITY DRIVE, MOLINE, ILLINOIS

On-Site



With Senator Durbin



**3. AESTHETICALLY
PLEASING APPEARANCE**

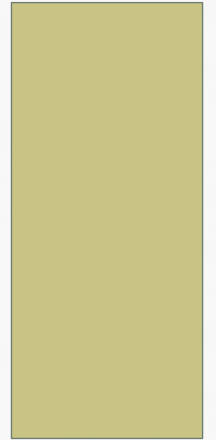

UNIVERSITY HOUSING AND DINING MASTER PLAN UPDATE

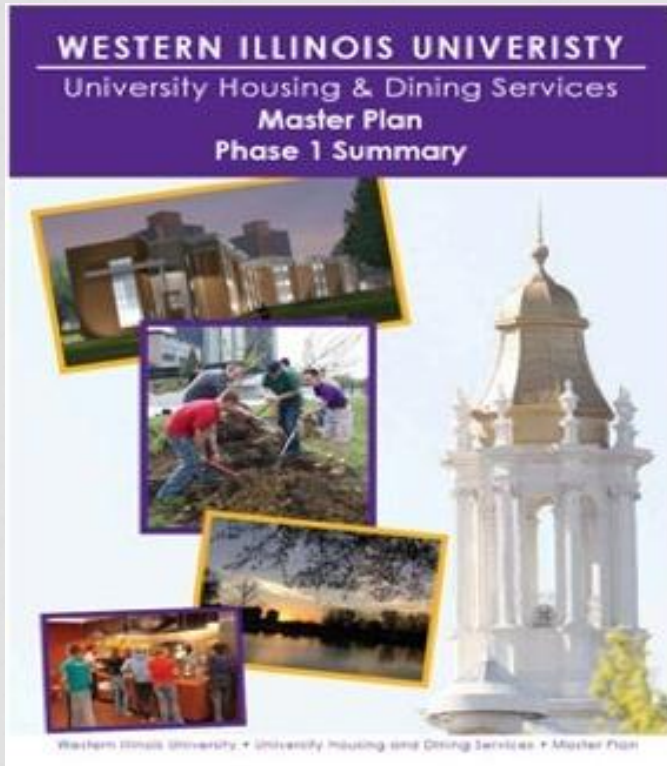

2012 Projects

- ✓ Corbin and Olson renovation complete
- ✓ Lincoln and Washington student room renovations (electrical upgrades, lighting improvements, and furniture replacement) and the 28 ADA bathroom renovations complete.
- ✓ Thompson Hall abatement complete

UNIVERSITY UNION



UNION RENOVATION: PHASE I



- Phase I renovation focuses on the northwest entrance of the Union, Lamoine Room, and Murray St. Café.

TARGET WESTERN FORWARD: NEW WEIGHT ROOM EQUIPMENT



TARGET WESTERN FORWARD: NEW PRACTICE COURT BROPHY HALL

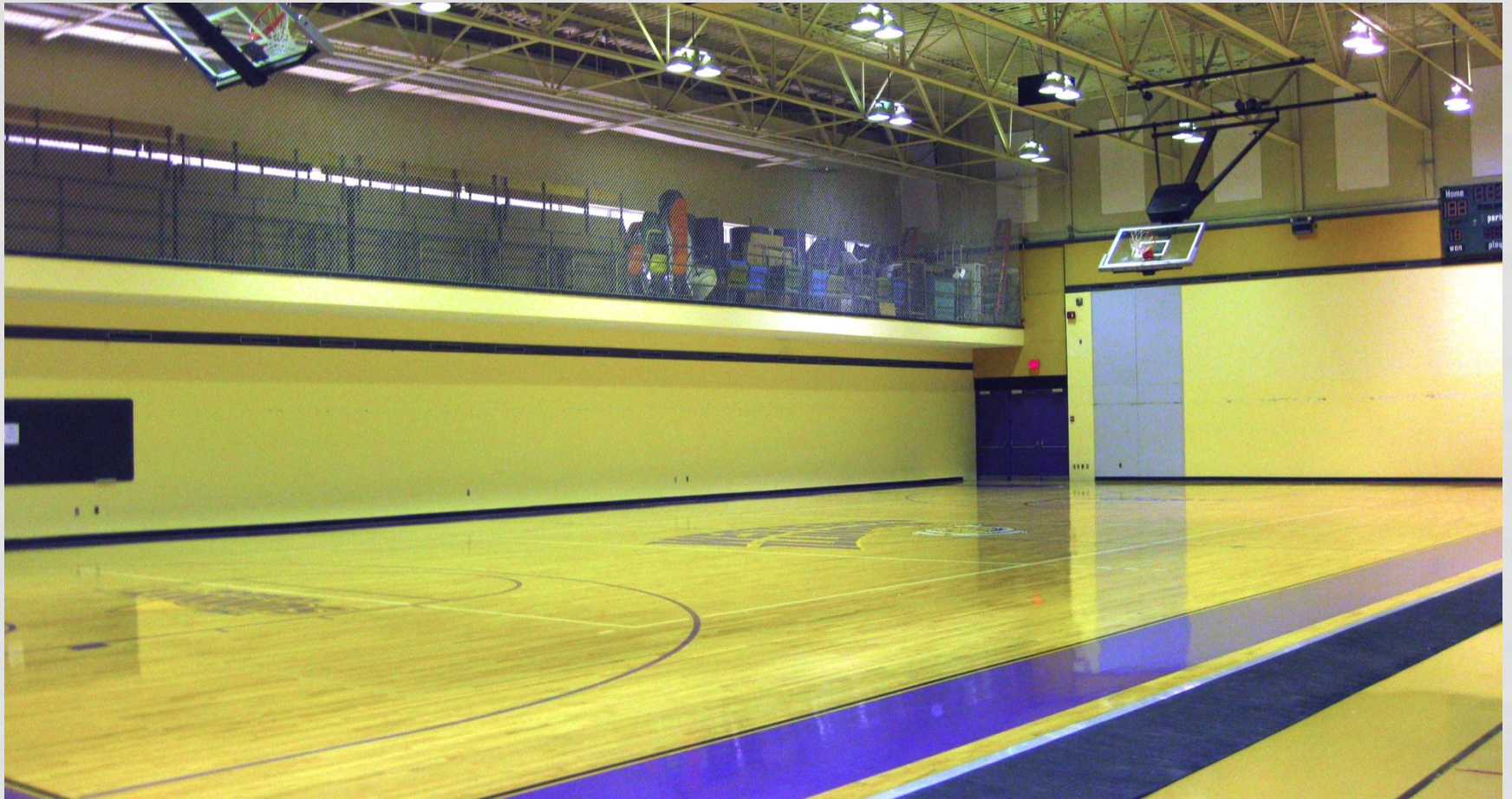

“METAL BUILDING”



“METAL BUILDING”



WETZEL HALL IMPLOSION JULY 2012



WETZEL PARK DECEMBER 2012



SUSTAINABILITY: AWARD WINNING DESIGN

QC River Action



QC River Council



SUSTAINABILITY: UNIVERSITY FARMS



- University Technology will be extending fiber to University Farms.
- Support instruction and research (tests on alternative crops, organics, soybeans, weed trails, bulls, rams, and goats)

SUSTAINABILITY: NAHANT MARSH



- WIU-QC and EICCD Sign an Agreement
 - 513 Acre Nature Conservancy
 - Laboratory
 - Classroom
 - Computer Room
 - Classes in Arts and Sciences and Education and Human Services

4. ACCOMMODATING GROWTH

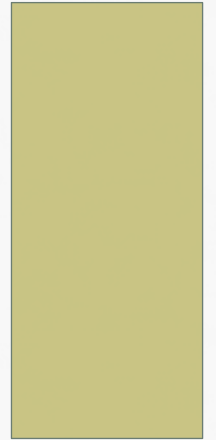

PERFORMING ARTS CENTER



- 1,400-seat proscenium theatre auditorium
- 250-seat thrust stage
- 150-seat studio theatre
- All supporting student convocations, recitals, theatre and dance productions, Bureau of Cultural Affairs programs, Performing Arts Series events, lectures, graduation ceremonies, local arts, and civic functions.

RIVERFRONT PHASE II

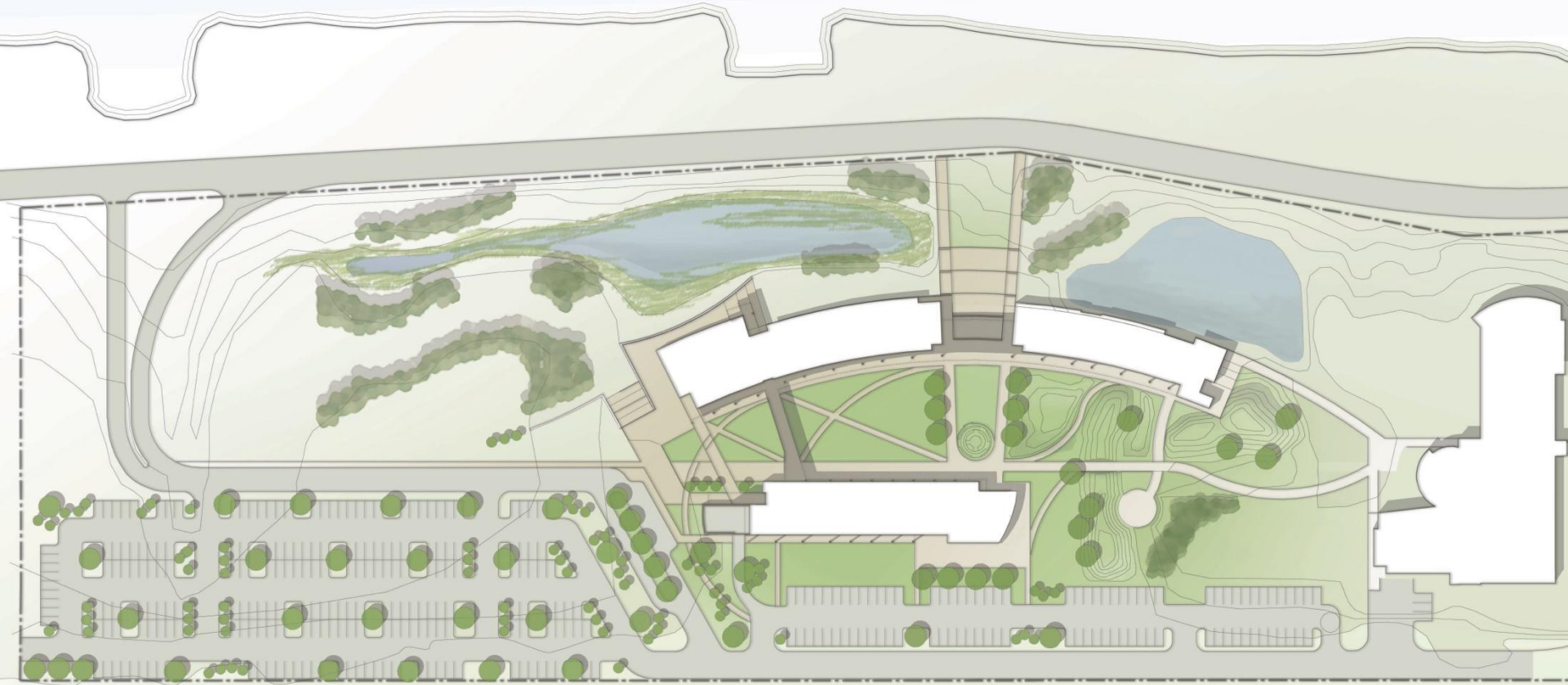

siteplan

FORMAL ENTRY



Perspective_North Elevation

SOUTH BUILDING



Perspective_Courtyard

OTHER SIDE OF SOUTH BUILDING



Perspective_South Entry

LONG TERM GROWTH: FY13 CAPITAL RECOMMENDATIONS

- 1. Macomb Campus Utility Infrastructure
- 2A. Science Building Planning
- 2B. QC Riverfront Campus-Phase III
- 3. Life/Safety and Accessibility Enhancements
- 4. Visual Arts Center Planning
- Capital Renewal

MACOMB CAMPUS UTILITY INFRASTRUCTURE (\$57.8 MILLION)

- Replacing cooling capacity for the buildings
- Heating Plant upgrades
- Electrical upgrades

PLANNING FOR SCIENCE COMPLEX (\$11.5 MILLION)



- Modernize facilities supporting scientific instruction and research in:
 - Currens Hall
 - Tillman Hall
 - Waggoner Hall

RIVERFRONT PHASE III

(\$34.7 MILLION)

- Completes construction of the new campus that serves a regional population of 400,000 residents and leverages \$175 million in private investment and foundation support for education, entrepreneurship, technology, new jobs, and economic development.

LIFE SAFETY AND ACCESSIBILITY

(\$22.0 MILLION)

- The University is seeking state funding to comply with:
 - Current electrical and mechanical provisions of the *Life Safety Code*,
 - *Americans with Disabilities Act Accessibility Guidelines*
 - *Illinois Accessibility Code*.

PLANNING FOR VISUAL ARTS CENTER (\$8.3 MILLION)



- Address Inadequate instructional and design spaces
- Address inadequate environmental protection and ventilation concerns
- Consolidate locations for increased operational efficiencies
- Art is currently located in Garwood, Sallee, and the Heating Plant Annex

5. STRONG INFRASTRUCTURE

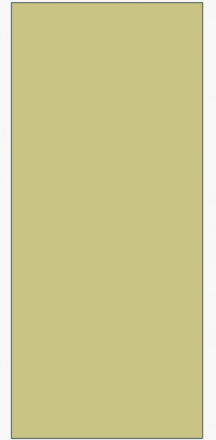

CURRENT STATE FUNDED CAPITAL RENEWAL PROJECTS



- Replace Brophy Hall chiller
- Replace failing cooling system for the University Data Center
- Replace the electrical switchgear feeding the campus

UNIVERSITY DATA CENTER (MORGAN 103)



- Should the room exceed 80 degrees, University equipment including access to servers, Internet, e-mail, mainframe, and distance learning would shut down

SWITCHYARD BY HORRABIN



MACOMB STEAMLINES



NEW LIGHTS IN UNIVERSITY DRIVE MACOMB

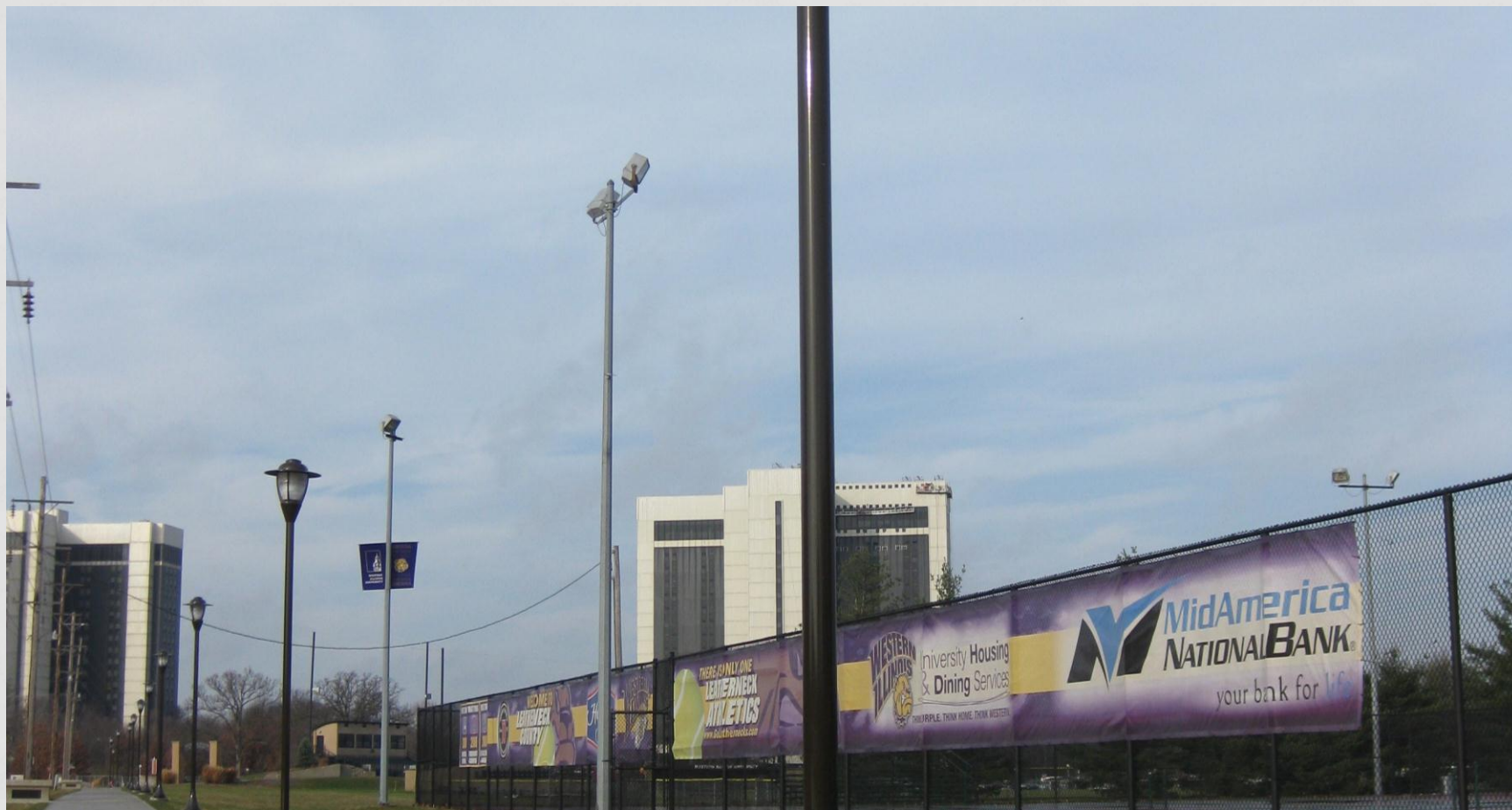

THOMPSON HALL



DECEMBER 2010 COPS PROJECTS TO BE COMPLETED BY SPRING 2013

- Steam line replacement
- Roof replacements
 - University Union
 - Morgan Hall
 - Browne Hall
 - Waggoner Halls
- Simpkins Hall chiller replacement
- HVAC work at Beu, Brophy, Currens, Horrabin, Morgan, Stipes, and Waggoner Halls is complete.

6. COMMUNITY INTERFACE

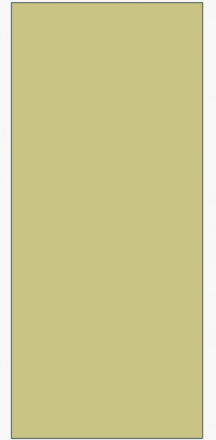

FIRST APPEARANCES:
306 W. UNIVERSITY AVENUE MACOMB



FIRST APPEARANCES: 306 W. UNIVERSITY AVENUE MACOMB



FIRST APPEARANCES: ALVIN AND ELAINE GOLDFARB ATRIUM



FIRST APPEARANCES: QC BANNERS AND WINDSCREENS



FIRST APPEARANCES: MACOMB BANNERS



FIRST APPEARANCES: MACOMB WINDSCREENS



RIVERFRONT DEVELOPMENT PROJECT



MOLINE, IL | AUGUST 6, 2012

Development Vision



WIU Quad Cities



Riverfront Development



Moline Multi-Modal Station



Phase I Programming



Student Housing

1

Café
Quick Serve
Book Store
Sandwich Shop
Clothing Store
Restaurant

Grocery Store

Pharmacy

Phase II Programming



Market-Rate Housing

2

Administration Building

Casual Dining

Retail Shops

Phase III Programming



Vertical Expansion of Phases I-II

Retail Shops

3

Movie Theater

Market-Rate Housing



Phase I - Student Housing and Public Open Space



Phase I - Retail Shops and Amenities

Sustainable Design Features



SOLAR ELECTRIC ARRAYS



VEGETATED "GREEN" ROOFS

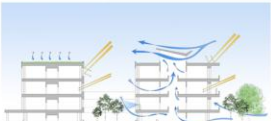

VENTILATION AND DAYLIGHT



WATER PERMEABLE PAVING



GEO THERMAL HEAT & COOLING



Transportation Diagram

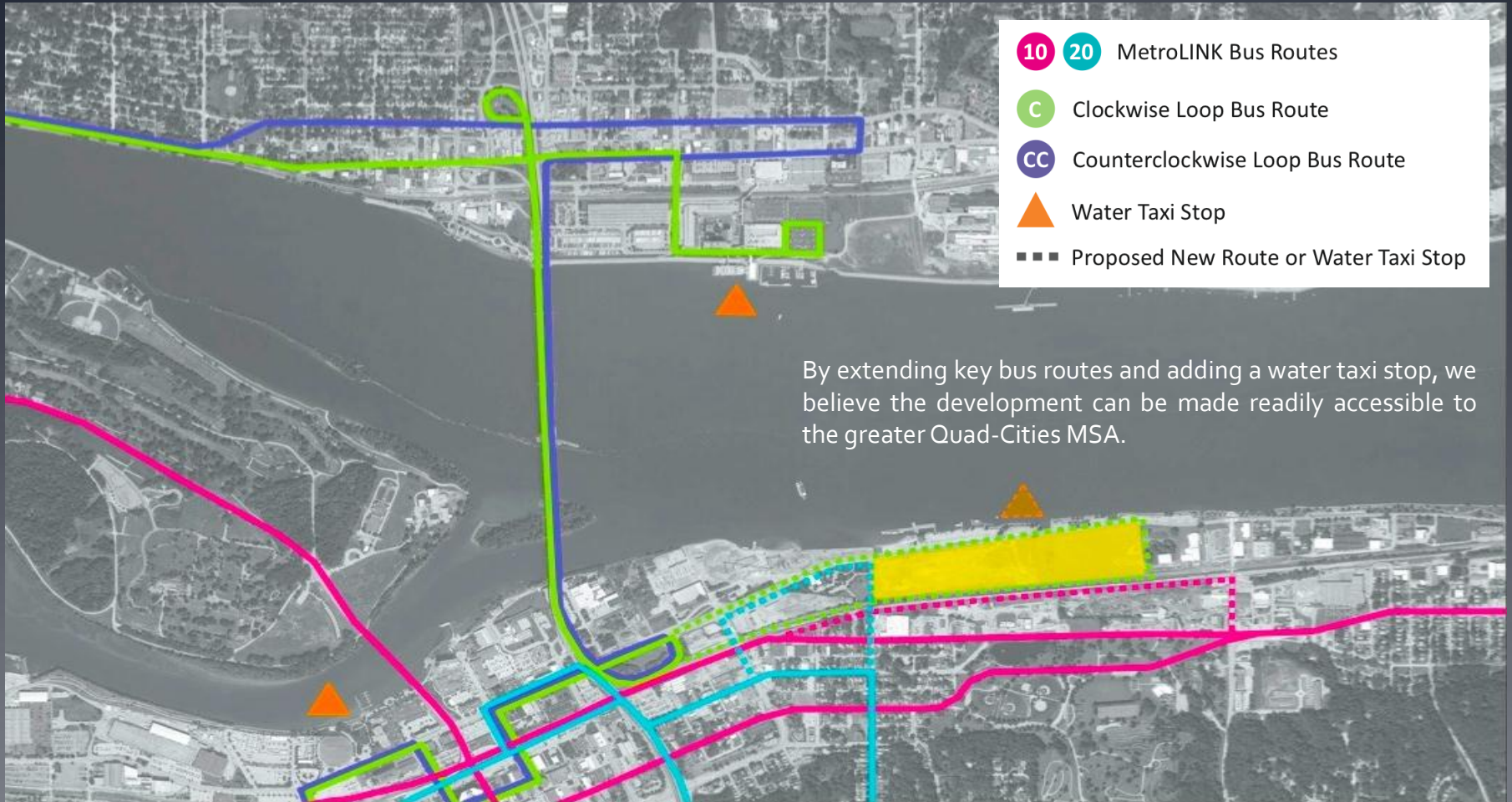

7. Flexibility

Advancements to our facilities and infrastructure not foreseen at the time of writing Campus Master Plans

Flexibility

- Go West Bus Garage
- Thompson Hall Renovation
- New Campus Welcome Center
- New Broadcasting Tower for WIUM
- Expanded psychiatric services in Seal Hall
- Trinity MedXpress at WIU-QC
- Changing the function of Heating Plant Annex

Summary

- Macomb Campus Master Plan 20 Year Vision
 - It contains 48 actions
 - 75% are complete, in progress, or carried forward in the Master Plan Update
- Quad Cities Master Plan is a 20 Year Vision
 - Phase I opens January 2012
 - Phase II ready for construction
 - Phase III seeking funding



Fiscal Year 2012 Master Plan Update

WE ARE GETTING THE JOB DONE!